

## **ROLLER MILL Compact Type**

MTR

A compact test roller mill with a simplified structure and functions

The roller cover can be replaced with an optional SUS roller cover. A feeder can also be attached. We offer various feeders, such as electromagnetic feeders and screw feeders, to accommodate different materials.



High quality, long-lasting rollers developed by Meiji Machine

The MTR uses dual centrifugal chilled rollers created using a special manufacturing method developed by Meiji Machine. The roller shell provides exceptional product safety, through

uniform roller hardness and thermal conductivity, and the elimination of pinholes. The rolls are manufactured at our group company under strict quality control.

Ideal for milling small quantities

The MTR can be used to easily mill small quantities of materials, stock, products, etc., in laboratories, testing rooms, and factories.

Minimum size

Its compact size enables it to be used in various locations. It also has casters for easy movement and installation.

Controlled via dedicated app

The fixed and swing side RPM can both be easily controlled via a smartphone or tablet. The app can also be used to confirm operating conditions and save test conditions.

[MTR]

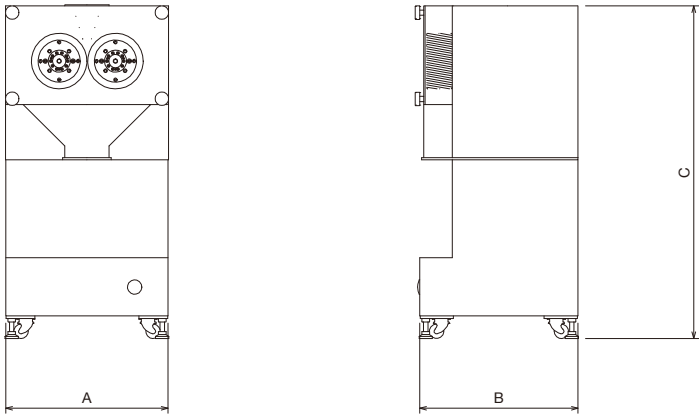

Specifications and dimensions

| Model   | Roller [mm] |        | External dimensions [mm] |     |       | Weight [kg] |
|---------|-------------|--------|--------------------------|-----|-------|-------------|
|         | Diameter    | Length | A                        | B   | C     |             |
| MTR-250 | 250         | 100    | 736                      | 736 | 1,502 | 600         |

\* Please contact us directly for details. \* Specifications are subject to change for improvement purposes without prior notification.

